



Equipment for the Foodservice Industry

Project Name: _____
Product Number: _____
Quantity: _____

CLASSIC CHILL BACKBAR FRIDGES WITH GLASS DOORS

General

All steel construction for durability, the back bar refrigerators are available in 3 sizes to fit your needs.

Cabinet Construction

The exteriors are covered in attractive black vinyl; the counter top is made with Type 304 Stainless Steel.

The interiors are made from Type 304 Stainless Steel and have an energy efficient LED lamp installed and come equipped with PVC coated shelves.

The entire unit is built using a high density polyurethane insulation that is foamed in place.

Doors

The doors are equipped with locks for security.

The glass doors provide easy viewing so less time with the door open looking for what is needed

The gasket is magnetized to provide easy removal for cleaning.

Self-closing doors.

Refrigeration

Oversized, factory balanced refrigeration is designed to hold 33 to 38 degrees Fahrenheit.

The refrigeration system uses R134A that is CFC and HCFC free.

Condenser unit is easily accessible for routine cleaning and maintenance.

Electrical

Units come factory wired and ready to connect with 115/60/1 phase, 15 amp dedicated plug and cord.



CBBGD2-48CC



CBBGD2-60CC



CBBGD3-72CC

MODEL	CBBGD2-48CC	CBBGD2-60CC	CBBGD3-72CC
EXTERNAL DIMENSIONS			
Overall Width inches / mm	48.8" / 1240mm	60.8" / 1544mm	72.8" / 1848mm
Overall Depth inches / mm	24.4" / 620mm	24.4" / 620mm	24.4" / 620mm
Overall Height inches / mm	36.2" / 920mm	36.2" / 920mm	36.2" / 920mm
Number of Doors	2	2	3
INTERNAL DIMENSIONS			
Capacity Cubic ft. / litres	11.8 / 335	15.8 / 446	19.6 / 556
Internal Width inches / mm	36.2" / 920mm	48.2" / 1224mm	60.2" / 1528mm
Internal Depth inches / mm	18.5" / 470mm	18.5" / 470mm	18.5" / 470mm
Internal Height inches / mm	30.5" / 775mm	30.5" / 775mm	30.5" / 775mm
Number of shelves	4	4	6
ELECTRICAL			
Full Load Amperes 115/60/1	6.4	6.4	7.4
Cord Length Feet / Meters	7.2 / 2.2	7.2 / 2.2	7.2 / 2.2
Plug type	NEMA 5-15P	NEMA 5-15P	NEMA 5-15P
REFRIGERATION DATA			
Refrigerant	R134a	R134a	R134a
Horsepower	1/3	1/3	1/3
WEIGHT			
Gross Weight lbs / kg	315 / 143	380 / 173	410 / 186

FRONT ELEVATIONS

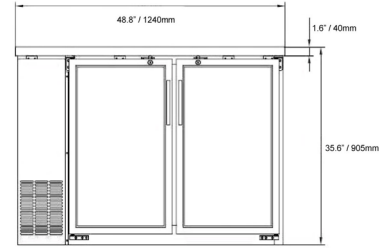

CBBGD2-48CC

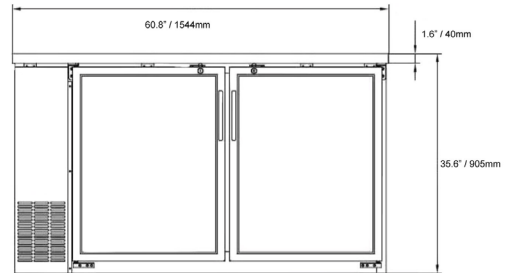

CBBGD2-60CC

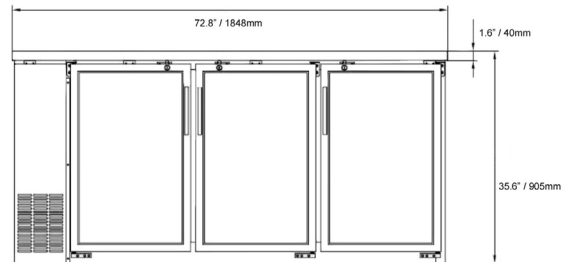

CBBGD3-72CC

SIDE ELEVATION

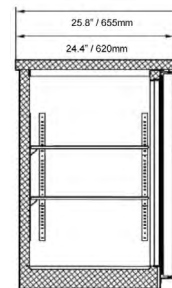

EFI Sales Ltd. (604) 607-8850
 Corporate Office (888) 565-9920 Toll Free
 26895 Gloucester Way (604) 607-8820 Fax
 Langley, BC V4W 3Y3 info@efifoodequip.com

Distribution Facilities:
 Toronto, ON
 Langley, BC