



Equipment for the Foodservice Industry

Project Name: \_\_\_\_\_  
Product Number: \_\_\_\_\_  
Quantity: \_\_\_\_\_

## **CLASSIC CHILL BACKBAR FRIDGES WITH SOLID DOORS**

### **General**

All steel construction for durability, the back bar refrigerators are available in 3 sizes to fit your needs.

### **Cabinet Construction**

The exteriors are covered in attractive black vinyl; the counter top is made with Type 304 Stainless Steel.

The interiors are made from Type 304 Stainless Steel and have an energy efficient LED lamp installed and come equipped with PVC coated shelves.

The entire unit is built using a high density polyurethane insulation that is foamed in place.

### **Doors**

The doors are equipped with locks for security.

The gasket is magnetized to provide easy removal for cleaning.

Self-closing doors equipped with the "stay open" feature when opened past 90 degrees.

### **Refrigeration**

Oversized, factory balanced refrigeration is designed to hold 33 to 38 degrees Fahrenheit.

The refrigeration system uses R134A that is CFC and HCFC free.

Condenser unit is easily accessible for routine cleaning and maintenance.

### **Electrical**

Units come factory wired and ready to connect with 115/60/1 phase, 15 amp dedicated plug and cord.



CBBDR2-48CC



CBBDR2-60CC



CBBDR3-72CC

MODEL	CBBDR2-48CC	CBBDR60-2CC	CBBDR3-72CC
<b>EXTERNAL DIMENSIONS</b>			
Overall Width inches / mm	48.8" / 1240mm	60.8" / 1544mm	72.8" / 1848mm
Overall Depth inches / mm	24.4" / 620mm	24.4" / 620mm	24.4" / 620mm
Overall Height inches / mm	36.2" / 920mm	36.2" / 920mm	36.2" / 920mm
Number of Doors	2	2	3
<b>INTERNAL DIMENSIONS</b>			
Capacity Cubic ft. / litres	11.8 / 335	15.8 / 446	19.6 / 556
Internal Width inches / mm	36.2" / 920mm	48.2" / 1224mm	60.2" / 1528mm
Internal Depth inches / mm	18.5" / 470mm	18.5" / 470mm	18.5" / 470mm
Internal Height inches / mm	30.5" / 775mm	30.5" / 775mm	30.5" / 775mm
Number of shelves	4	4	6
<b>ELECTRICAL</b>			
Full Load Amperes 115/60/1	6.4	6.4	7.4
Cord Length Feet / Meters	7.2 / 2.2	7.2 / 2.2	7.2 / 2.2
Plug type	NEMA 5-15P	NEMA 5-15P	NEMA 5-15P
<b>REFRIGERATION DATA</b>			
Refrigerant	R134a	R134a	R134a
Horsepower	1/3	1/3	1/3
<b>WEIGHT</b>			
Gross Weight lbs / kg	315 / 143	380 / 173	410 / 186

**FRONT ELEVATIONS**

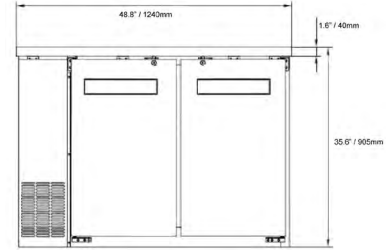

**CBBDR2-48CC**

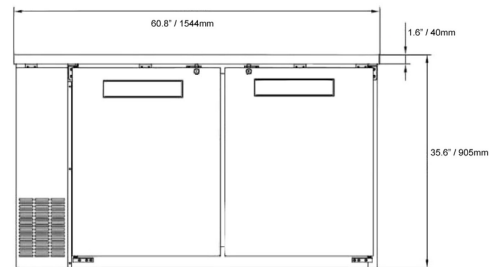

**CBBDR2-60CC**

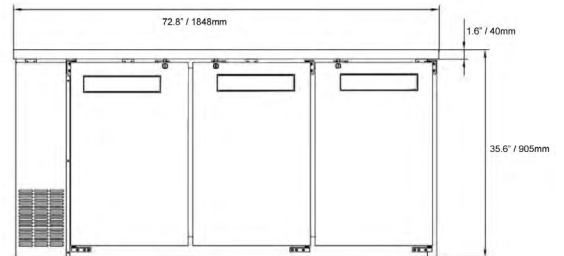

**CBBDR3-72CC**

**SIDE ELEVATION**

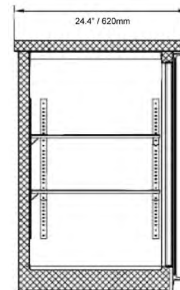

EFI Sales Ltd.  
 Corporate Office  
 26895 Gloucester Way  
 Langley, BC V4W 3Y3

(604) 607-8850  
 (888) 565-9920 Toll Free  
 (604) 607-8820 Fax  
 info@efifoodequip.com

Distribution Facilities:  
 Toronto, ON  
 Langley, BC